

Courses & Dist<sup>ce</sup>  
up Juniata

S. 66. W. 140
S. 55. W. 34
S. 66. W. 70
S. 40. W. 34
278

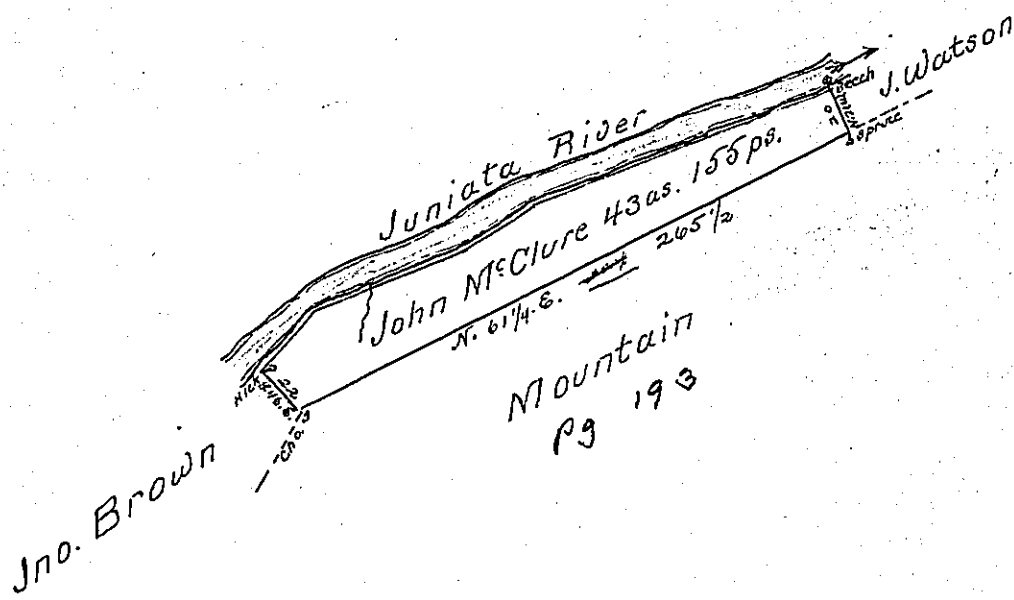

A draught of a tract of land situate in Millford township in Mifflin County containing forty three acres, one hundred & fifty five perches & the usual allowance of six per cent. for roads &c. which from official papers remaining in my office appears to have been surveyed for John McClure April 4th. 1794 in pursuance of a Warrant dated January the 28th. 1793 examined by me this 12th. of Feby. 1806 and found correct.

pr.

William Harris D.S.

To Samuel Cochran Esqr }  
 Survey Genl. }

IN TESTIMONY that the above is a copy of the original remaining on file in the Department of Internal Affairs of Pennsylvania, made conformably to an Act of Assembly approved the 16th day of February, 1833, I have hereunto set my Hand and caused the Seal of said Department to be affixed at Harrisburg, this fourth day of March 1902

*James W. Latta*  
 Secretary of Internal Affairs.